



24" Marvel Outdoor Dispensers for Beer or Wine

Model # MO24BNS & MO24BNSM

Performance

- CSA certified for outdoor use to withstand elements like rain, corrosion, high humidity and heat
- Tested to perform in temperatures as high as 115° F
- Dynamic cooling technology delivers rapid cool down, frost-free operation and precise temperature stability
- Thermal-efficient insulated cabinet ensures optimum energy efficiency and cooling performance
- Easy-to-clean integrated drain system keeps spillage under control
- Double-insulated tower reduces foam on pour and prevents condensation

Storage Capabilities

- 5.7 cu. ft. capacity
- The original dispenser to store half barrel, quarter barrel (pony keg), sixth barrels or Cornelius kegs, slim quarters, growlers, bottles or cans
- Lo-Boy coupler makes it easier to store, tap and swap out tall U.S. type D half barrels
- (2) exclusive stow-on-board shelves convert unit to an all-refrigerator capable of storing perishables
- Secure gas tank storage area and drain basin
- Anti-scuff interior floor shield and stainless steel threshold protect against cabinet wear and tear from loading and unloading kegs
- Rear port for external gas tank option

Temperature Controls

- Marvel Prime™ controls for precise, frost-free temperature management between 34° and 60° F
- Audible alarms for door ajar and high/low temperature ensure your contents stay at optimal temperature

Aesthetics

- Corrosion-resistant stainless steel exterior, sturdy pro-style handle and rugged stainless steel toe kick
- Beer and wine tap kits with single or twin tap options
- Finish: stainless steel

Additional Convenience

- Door lock provides added safety and security
- Stainless steel toe kick adjustable to 4" with leveling legs
- 1-year parts and labor warranty, 5-year sealed system parts warranty



Now available with single or twin wine taps



Mobile unit features locking casters and stainless steel mug rail

Ordering Options

STEP ONE: CHOOSE YOUR BASE

Built-in Cabinet	
Stainless Steel Door, Right Hinge	MO24BNS2RS
Stainless Steel Door, Left Hinge	MO24BNS2LS
Mobile Cabinet	
Stainless Steel Door, Right Hinge	MO24BNSMRS
Stainless Steel Door, Left Hinge	MO24BNSMLS

STEP TWO: CHOOSE YOUR TAP*

Wine	
Wine Single Tap Kit with Nitro Tank and Fittings	S42418647-ACCY
Wine Twin Tap Kit with Nitro Tank and Fittings	S42418648-ACCY
Beer	
Single Tap Kit with CO ₂ Tank and Fittings	S42418645-ACCY
Twin Tap Kit with CO ₂ Tank and Fittings	S42418646-ACCY

*Includes tower/tap, regulator, Lo-Boy copuler, gas hose, hose clamps, faucet wrench, tower gasket, tower mounting screws, gas tank, drain pan for undercounter installation

Product Dimensions

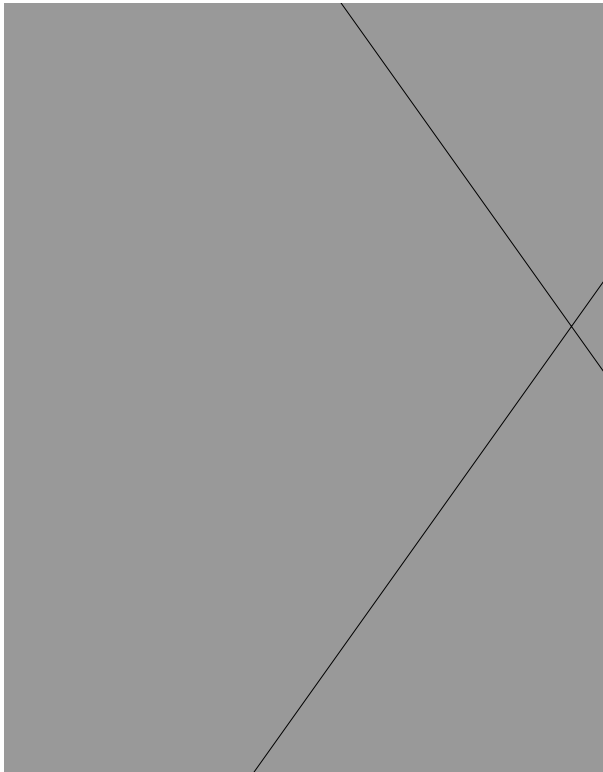
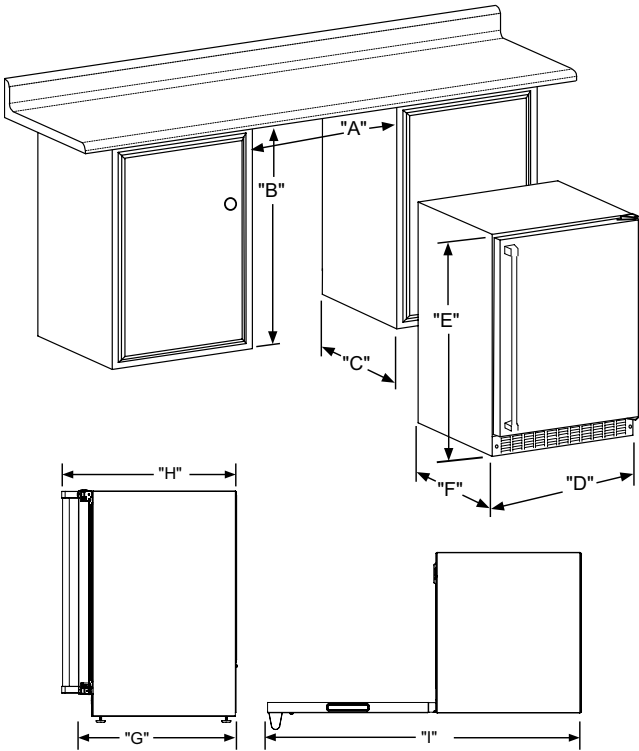

Rough-In Dimensions

A. Rough-In Width	24"
B. Rough-In Height	34" to 35"
C. Rough-In Depth	24"

Product Dimensions

D. Width	23 7/8"
E. Height	33 3/4" to 34 3/4" (Built In) 36 13/16" (Mobile)
F. Depth	21 1/2"
G. Depth to Front of Door	23 23/32"
H. Depth to Handle	26 1/4"
I. Depth with door at 90°	46 13/32"

Product Features

Interior Cabinet Finish	White
Capacity	5.7 cu. ft. Stores half barrel, quarter barrel (pony keg), sixth barrels/ Cornelius kegs, slim quarters, growlers, bottles or cans
Shelving System	Stow-on-Board
Shelf Fronts	Stainless Steel
Other Storage	Drain pan, CO2 tank, hoses, regulator, floor shield
Interior Lighting	NA
Toe Grill Finish	Stainless Steel
Hinge	Classic Hinge
Handle	Professional
Control Type	Prime™
Temperature Range	34° to 60° F
Lock	Yes
Electrical Requirements	120V / 60Hz / 15A
Length of Power Cord	6'
Shipping Weight	160 lbs
Finishes	Stainless Steel
Vacation Mode	No
Agency Approvals	NA

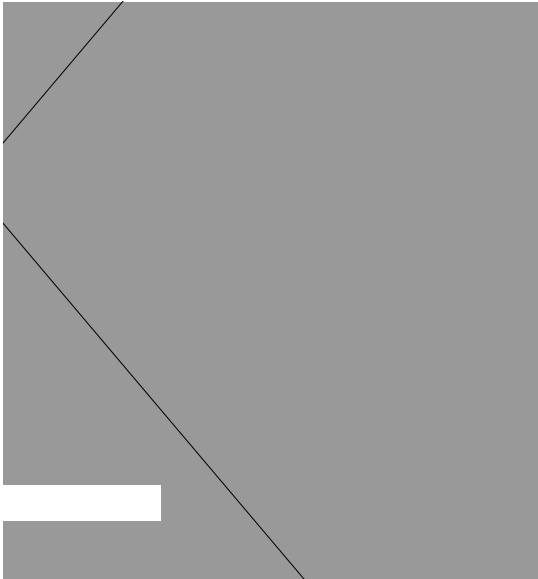

For comprehensive installation instructions, please visit www.marvelrefrigeration.com to access the owner's guide.